

SIS-SW

STEEL IDLE SPROCKETS

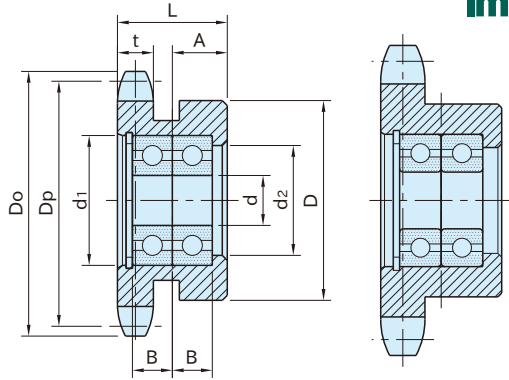

SIS-SW 313~512

SIS-SW 612,812

| Sprocket | Bearing / Retaining Ring |
|--|--------------------------|
| Steel(S45C) Induction hardened(teeth top) Black oxide finish | Steel |

| Part Number | Chain No. | No. of Teeth | Do | Dp | d | B | D | L | t | d ₁ |
|-----------------|-----------|--------------|-----|-------|----|----|----|----|------|----------------|
| SIS313SW | 35 | 13 | 44 | 39.80 | 10 | 6 | 32 | 20 | 4.3 | 22 |
| SIS412SW | 40 | 12 | 55 | 49.07 | | 8 | 40 | 22 | 7.2 | 26 |
| SIS512SW | 50 | | 69 | 61.34 | | | 50 | 25 | 8.7 | |
| SIS612SW | 60 | | 83 | 73.60 | 15 | 11 | 51 | 32 | 11.7 | 35 |
| SIS812SW | 80 | | 110 | 98.14 | 20 | 14 | 67 | 40 | 14.6 | 47 |

| Part Number | d ₂ | A | Bearing | Weight (g) | Proper Idler Pin |
|-----------------|----------------|------|----------|------------|------------------|
| SIS313SW | 18 | 10 | 6900ZZ×2 | 83 | PID1012 |
| SIS412SW | 22 | 11 | 6000ZZ×2 | 94 | PID1016 |
| SIS512SW | | 12.5 | | 350 | |
| SIS612SW | 28 | 16 | 6202ZZ×2 | 554 | PID1522 |
| SIS812SW | 39 | 20 | 6204ZZ×2 | 1,070 | PID2028 |

Features

The ball bearing is locked by a retaining ring.

Reference

· TENSIONER ASSEMBLY EXAMPLES

Technical Information

Allowable Bearing Radial Loads(N)<for 3,000 hours of average service life>

| Bearing | Speed (min ⁻¹) | | | | | |
|-----------------|----------------------------|------|------|------|------|------|
| | 100 | 200 | 300 | 500 | 1000 | 1500 |
| 6900ZZ×2 | 1210 | 950 | 840 | 710 | 560 | 480 |
| 6000ZZ×2 | 2210 | 2200 | 1920 | 1760 | 1030 | 900 |
| 6202ZZ×2 | 3740 | 2960 | 2600 | 2180 | 1740 | 1520 |
| 6204ZZ×2 | 6240 | 4950 | 4330 | 3650 | 2900 | 2530 |