

QCIC-F

ONE-TOUCH INDEXING CLAMPS



QCIC-F-2P

(ON Position)

QCIC-F-2P

(OFF Position)



QCIC-F-2P

(Without Spring Pressure)



QCIC-F-3P

(With Spring Pressure)

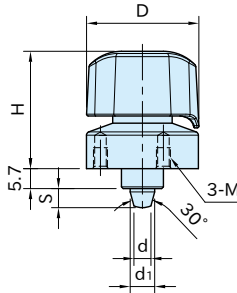
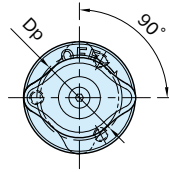

(ON Position)

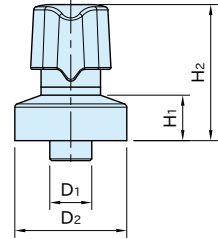

(OFF Position)

Body	Tapered Pin	Indicator	Knob
SCM440 steel Electroless nickel plated	SCM435 steel Electroless nickel plated	A5056 aluminum alloy Anodized Red	Polyamide (glass-fiber reinforced) Black

★ Key Point

Locating and clamping at once
Easy to read ON/OFF position

Size	Proper Plate Thickness	D	D ₁ (^{-0.01} / _{-0.03})	D ₂	H	H ₁	H ₂	d	d ₁	S	M	D _p	Proper Tapered Bushings
QCIC05F26	6~14	26	10	26	29	11	33	3.3	5	4.2	M3×0.5 Depth 5	20	QCIC05TB
QCIC07F32	6~15	32	12	32	34	13	39	4.9	7	5	M4×0.7 Depth 6	24	QCIC07TB

Part Number	Clamping Force (N)	Spring Pressure (N)	Weight (g)
QCIC05F26-2P	140	—	60
QCIC07F32-2P	170	—	105
QCIC07F32-3P		9	110

QCIC-TB TAPERED BUSHINGS



Supplied With

- **QCIC05F26**: 3 of socket-head cap screws(Stainless Steel), M3×0.5-6L
- **QCIC07F32**: 3 of socket-low-head cap screws(Stainless Steel), M4×0.7-8L

Feature

- Clamping by the tapered pin allows locating and fixing with no clearance at once.
- Use with the dedicated tapered bushing.
- ON/MID/OFF mark on the body and the knob position allow to visually recognize clamping or unclamping.
- The red indicator appears to show the unclamping state when the knob is in OFF position.

■ Without Spring Pressure

2 positions of ON/OFF

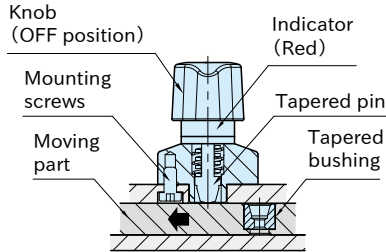

Knob is in OFF position.

The tapered pin remains inside when releasing the knob.

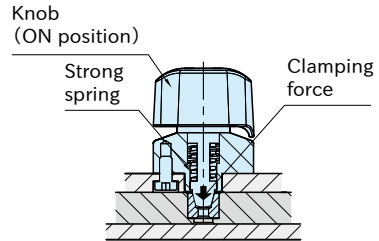

Knob is in ON position.

- Turn the knob to "ON" when the tapered pin and tapered bushing are aligned.
- Clamping force is generated by compressing strong spring and the tapered pin clamps the tapered bushing. The knob clicks when it is clamped.

■ With Spring Pressure

- 3 positions of ON/MID/OFF
- The plate is movable while receiving spring pressure of the coil spring inside the body.
- The tapered pin and tapered bushing automatically engage by spring pressure when they are aligned. (The knob positions in "MID".)

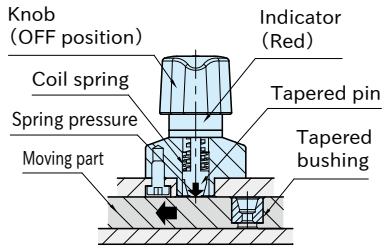

Knob is in OFF position.

- The tapered pin keeps pushed-out-state when releasing the knob. (The knob turns to "MID".)
- In MID position, the tapered pin does not retract into the body when colliding with the step and it can not pass through.

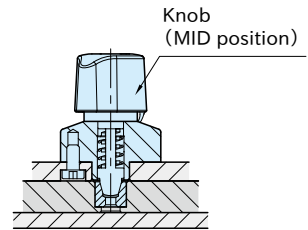
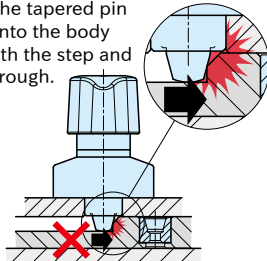

Knob is in MID position.

- The tapered pin and tapered bushing engage by spring pressure when they are aligned.
- The knob moves to "MID".
- Turn the knob from "MID" to "ON".
- Clamping force is generated by compressing strong spring and the tapered pin clamps the tapered bushing. The knob clicks when it is clamped.

 Continuing on Next Page

Technical Information

Size	Heatresistant Temperature(°C)	Allowable Load (N)
QCIC05F26	80	900
QCIC07F32		1300

Repeatability: ± 0.05

How To Use

■ Without Spring Pressure

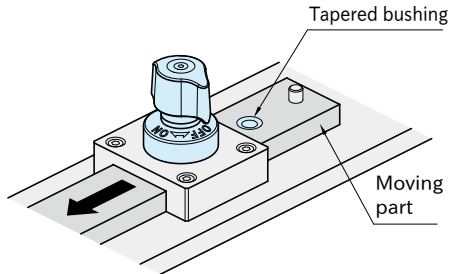

- ① Ensure that the knob is positioned at "OFF". Slide the moving part.

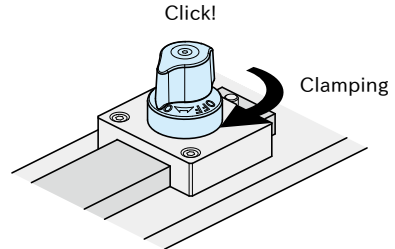
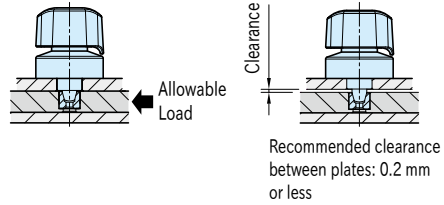

- ② Turn the knob to "ON" for clamping. The knob clicks when it is clamped.
 Note: For [QCIC-F-2P](#) (Without spring pressure), do not unclamp when the tapered pin is receiving axial load. (The tapered pin could not return due to structure.)

■ With Spring Pressure

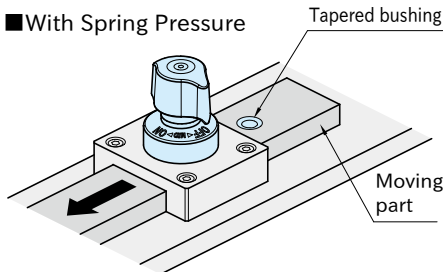

- ① Slide the moving part when the knob is positioned at "OFF".

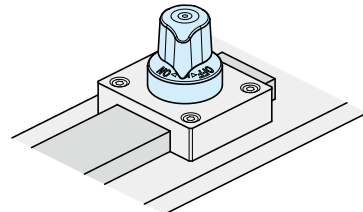

- ② The tapered pin and tapered bushing engage by spring pressure when they are aligned. The knob moves to "MID".

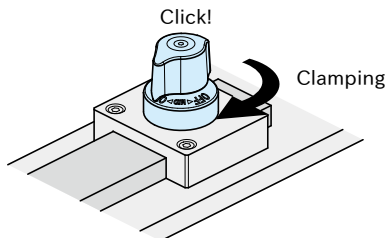

- ③ Turn the knob from "MID" to "ON" for clamping. The knob clicks when it is clamped.

Application Example

Locating and clamping for sliding plate

ONE-TOUCH INDEXING
CLAMPS
QCIC-F-P

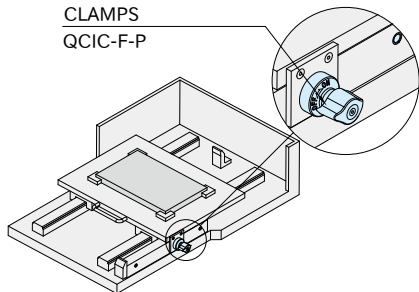

Locating and clamping for rotating unit

ONE-TOUCH INDEXING
CLAMPS
QCIC-F-P

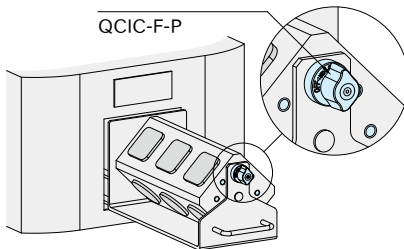

How To Install

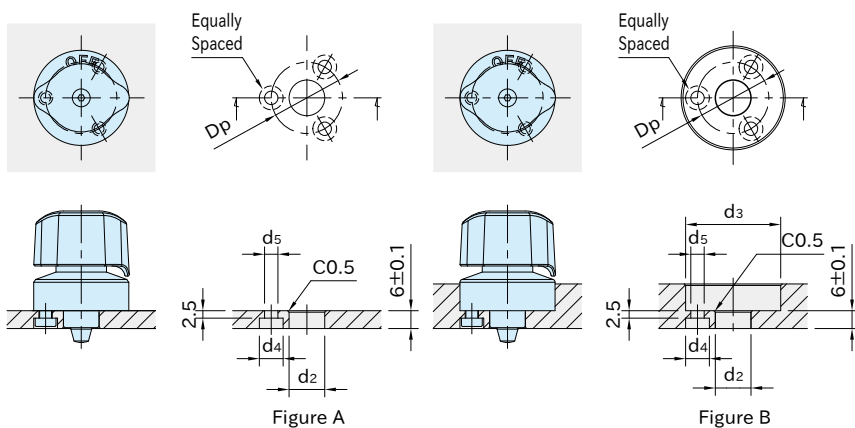

Figure A

Figure B

Size	Proper Plate Thickness	Figure	d ₂ (H7)	d ₃	d ₄	d ₅	Dp
QCIC05F26	6	A	10	—	6.5	3.4	20
	Over 6, 14 or less	B		27			
QCIC07F32	6	A	12	—	8	4.5	24
	Over 6, 15 or less	B		33			

Reference

"How To Install" of [QCIC-TB](#) Tapered Bushings.