

IMAO TIGHTENERS, Standard Series

Swing Type

The arm automatically swings depending on the chain or belt slack amount to adjust tension. The arm can be set at any desired position by pulling for disengagement from the base.

- ① Arm
- ② Spline Ring
- ③ Spline Shaft
- ④ Base
- ⑤ Shoulder Screw
- ⑥ Coiled Spring
- ⑦ Torsion Spring
- ⑧ Dry Bearing

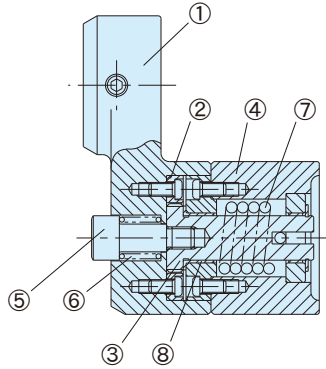

How To Change Arm Position

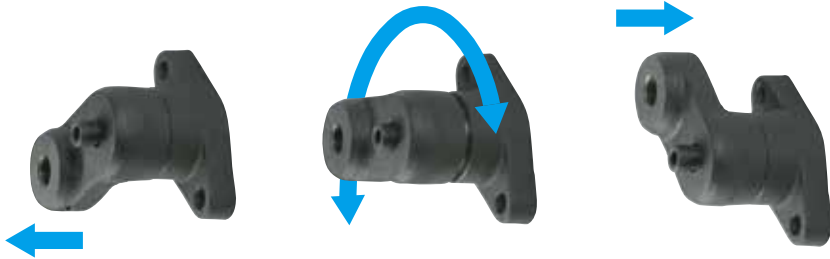

Pull the arm to disengage the teeth from the locking element.

Turn the disengaged arm to a desired position.

When the arm is released, the return spring automatically engages the teeth again.