

# PID IDLER PINS

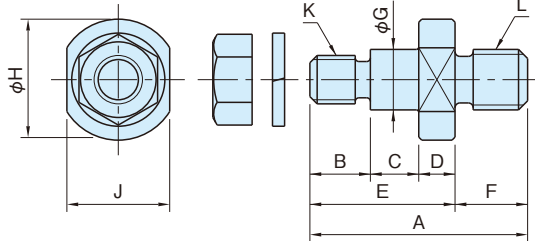

Type	Body
<b>PID</b>	Steel (S45C)
<b>PID-SUS</b>	Stainless steel (SUS303)

### PID (Steel)

Part Number	A	B	C	D	E	F	G	H	J	K	L	Weight (g)
<b>PID0606</b>	29.5	7	5.5	5	17.5	12	6	12	10	M 5×0.8	M 6×1	10
<b>PID0807</b>	33.5	9	6.5	6	21.5	12	8	16	13	M 6×1	M10×1.5	25
<b>PID1006</b>	36		6	9	24		10					30
<b>PID1012</b>	41.5	10	11.5	8	29.5	12	10	20	17	M 8×1.25	M10×1.5	34
<b>PID1008</b>	38		8		8							26
<b>PID1008L</b>	45	10	8	15	33	12	10	20	17	M 8×1.25	M10×1.5	55
<b>PID1016</b>	49.5			15.5	12							37.5
<b>PID1210</b>	62	15	9.5	15	39.5	22.5	12	23	19	M10×1.5	M16×2	130
<b>PID1511-M16</b>	67	19	10.5	15	44.5	22.5	15	25	22	M12×1.75	M20×2.5	150
<b>PID1511</b>												160
<b>PID1522</b>	78	19	21.5	15	55.5	22.5	15	25	22	M12×1.75	M20×2.5	170
<b>PID1529</b>	86											29.5
<b>PID2014</b>	73	22	13.5	15	50.5	22.5	20	32	27	M16×2	M20×2.5	310
<b>PID2028</b>	94											27.5
<b>PID2050</b>	117	22	50.5	22	94.5	22.5	20	32	27	M16×2	M20×2.5	370

### PID-SUS (Stainless Steel)

Part Number	A	B	C	D	E	F	G	H	J	K	L	Weight (g)
<b>PID1006-SUS</b>	36	9	6	9	24	12	10	16	13	M 6×1	M10×1.5	30
<b>PID1008-M16-SUS</b>	48.5	10	8	8	26	22.5	10	20	17	M 8×1.25	M16×2	70
<b>PID1511-M16-SUS</b>	67	19	10.5	15	44.5	22.5	15	25	22	M12×1.75	M16×2	130
<b>PID1511-SUS</b>												M20×2.5
<b>PID1522-M16-SUS</b>	78	19	21.5	15	55.5	22.5	15	25	22	M12×1.75	M16×2	150

**PID1008-M16-SUS**, **PID1511-M16-SUS** and **PID1522-M16-SUS** Idler Pins can mount on **AST180-SUS** Spring Tightener.