

CBS1 CHAIN BOLTS, Single-End

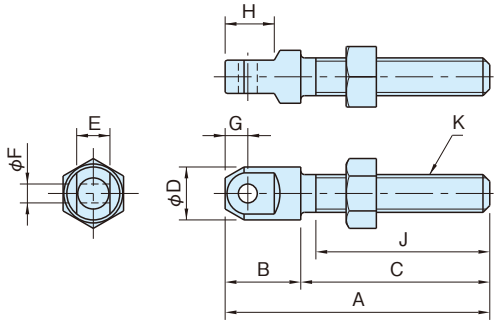

Type	Bolt	Nut
CBS1	Steel (SCM435) Black oxide finish	Steel
CBS1-L	Heat treated to Rc33-39	
CBS1-SUS	Stainless steel (SUS304)	Stainless steel

Type / Size	Chain No.	A	B	C	D	E	F	G	H	J	K	Weight (g)
CBS1	25	25	35	10	25	7	4.8	2.4	3	6.5	M 5×0.8	6
	35	35	45	15	30	10	7.4	3.7	4.5	10.5	M 6×1	15
CBS1-L	40	40	60	20	40	14	11.2	4	6	13	M 8×1.25	37
CBS1-SUS	50	50	75	25	50	17	13.8	5.2	7.5	16.5	M10×1.5	72
	60	60	90	30	60	21	17.8	6	9	19.5	M12×1.75	127
	80	80	120	40	80	27	22.6	8	12	26	M16×2	288
	100	100	150	50	100	33	27.5	9.6	15	32	M20×2.5	650

Steel				Stainless Steel	
Right-Hand Thread		Left-Hand Thread		Right-Hand Thread	
Part Number	Load Capacity (N)	Part Number	Load Capacity (N)	Part Number	Load Capacity (N)
CBS1- 25	950	CBS1- 25-L	950	CBS1- 25-SUS	530
CBS1- 35	2000	CBS1- 35-L	2000	CBS1- 35-SUS	1100
CBS1- 40	4100	CBS1- 40-L	4100	CBS1- 40-SUS	2200
CBS1- 50	6500	CBS1- 50-L	6500	CBS1- 50-SUS	3600
CBS1- 60	9500	CBS1- 60-L	9500	CBS1- 60-SUS	5300
CBS1- 80	17400	CBS1- 80-L	17400	CBS1- 80-SUS	9700
CBS1-100	26400	CBS1-100-L	26400	CBS1-100-SUS	14700

- Stainless steel Chain Bolts are available in right-hand thread only.
- Ensure that nobody stands under a lifting device where chain bolts are used.
- When Chain Bolts or chains are broken and serious damage is consequently conceivable, set a safety device to avoid danger.
- Chain Bolts must be inspected periodically and be replaced if necessary.
- The stated load capacity applies to tensile loads only.