

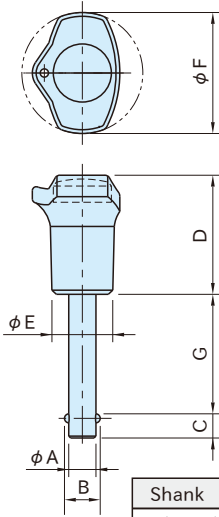

# BLP-SUS BALL LOCK PINS



Shank	Handle	Balls
Stainless steel (SUS303)	Polyamide plastic	Stainless steel (SUS420)

Part Number	A ( $-0.04$ $-0.08$ )	B	C	D	E	F	G ( $+0.6$ $0$ )	Recommended Hole Dia. (H11)	Min. Double Shear Strength (N)	Weight (g)
BLP05015-SUS	5	5.5	6	32.5	16	38	15	5	15.000	25
BLP05020-SUS							20			27
BLP05025-SUS							25			29
BLP05030-SUS							30			31
BLP06020-SUS	6	7	7	32.5	16	38	20	6	22.000	30
BLP06025-SUS							25			32
BLP06030-SUS							30			34
BLP06040-SUS							40			38
BLP06050-SUS	8	9.5	8	32.5	16	38	50	8	38.000	42
BLP08020-SUS							20			34
BLP08025-SUS							25			36
BLP08030-SUS							30			38
BLP08040-SUS	10	12	9	40	23	47	40	10	60.000	42
BLP08050-SUS							50			46
BLP10025-SUS							25			79
BLP10030-SUS							30			82
BLP10040-SUS	12	14.5	10	40	23	47	40	12	86.000	88
BLP10050-SUS							50			94
BLP12030-SUS							30			90
BLP12040-SUS							40			100
BLP12050-SUS	16	19	13	40	23	47	50	16	153.000	110
BLP16050-SUS							50			155

## How To Use

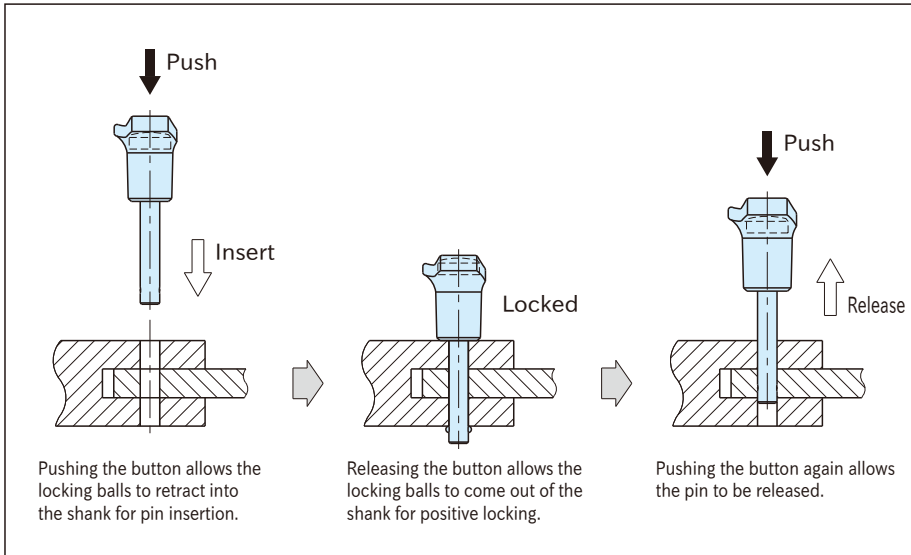

- Precision alignment pin that allows speedily locking and unlocking workpieces in jigs or fixtures.

## Related Product Page

- **BLP-C** CABLES FOR BALL LOCK PINS
- **BLP-R** RINGS FOR BALL LOCK PINS