

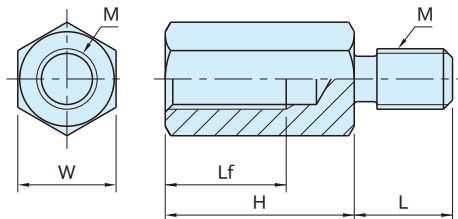

Steel



Stainless Steel



Type	Material & Finish
<b>BJ610</b> -06 <b>BJ610</b> -08	Steel (S45C) Quenched and tempered Black oxide finish
<b>BJ610</b> -10 <b>BJ610</b> -12 <b>BJ610</b> -16 <b>BJ610</b> -20 <b>BJ611</b>	Steel (S45C) Black oxide finish
<b>BJ610-SUS</b>	Stainless Steel (SUS304)

**BJ610** **BJ610-SUS**

Steel	Stainless Steel	M	H	L	Lf	W	Weight (g)
Part Number	Part Number						
<b>BJ610-06020</b>	<b>BJ610-06020-SUS</b>	M 6×1	20	10	12	10	13
<b>BJ610-06025</b>	<b>BJ610-06025-SUS</b>		25				17
<b>BJ610-06032</b>	<b>BJ610-06032-SUS</b>		32				20
<b>BJ610-08025</b>	-	M 8×1.25	25	13	16	13	25
<b>BJ610-08032</b>	-		32				35
<b>BJ610-08040</b>	-		40				45
-	<b>BJ610-08025-SUS</b>	M 8×1.25	25	13	16	14	32
-	<b>BJ610-08032-SUS</b>		32				40
-	<b>BJ610-08040-SUS</b>		40				50
<b>BJ610-10032</b>	<b>BJ610-10032-SUS</b>	M10×1.5	32	16	20	17	60
<b>BJ610-10050</b>	<b>BJ610-10050-SUS</b>		50				95
<b>BJ610-10075</b>	<b>BJ610-10075-SUS</b>		75				145
<b>BJ610-12032</b>	<b>BJ610-12032-SUS</b>	M12×1.75	32	18	20	22	95
<b>BJ610-12050</b>	<b>BJ610-12050-SUS</b>		50				165
<b>BJ610-12075</b>	<b>BJ610-12075-SUS</b>		75				250
<b>BJ610-16032</b>	-	M16×2	32	25	30	27	150
<b>BJ610-16050</b>	-		50				250
<b>BJ610-16075</b>	-		75				370
<b>BJ610-20050</b>	-	M20×2.5	50	30	40	30	290
<b>BJ610-20075</b>	-		75				430
<b>BJ610-20100</b>	-		100				580

**BJ611**

Part Number	M	H	L	Lf	W	Weight (g)
<b>BJ611-16032</b>	M16×2	32	30	20	27	155
<b>BJ611-16050</b>		50		30		275
<b>BJ611-16075</b>		75		375		

**Feature:**

Use to extend a contact bolt or the like.

**How To Use**