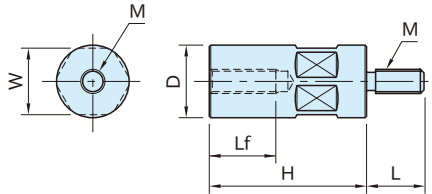

BJ600**CYLINDRICAL RISERS****ROHS**

Material : SCM435 steel for BJ600-08***

S45C steel for BJ600-12*** and BJ600-16***

Heat Treat : Quenched and tempered (BJ600-08*** only)

Finish : Black oxide

Part Number	M	H	L	Lf	D	W	Weight (g)		
BJ600-08032	M 8×1.25	32	19	20	24	22	105		
BJ600-08040		40					135		
BJ600-08050		50					170		
BJ600-08065		65					220		
BJ600-12050	M12×1.75	50	30	35	40	36	480		
BJ600-12065		65					640		
BJ600-12080		80					740		
BJ600-12100		100					940		
BJ600-12125		125					1,230		
BJ600-12160		160					1,570		
BJ600-12200	200	1,970							
BJ600-16050	M16×2	50	30	35	50	46	770		
BJ600-16065		65					1,000		
BJ600-16080		80					1,160		
BJ600-16100		100					1,470		
BJ600-16125		125			1,920				
BJ600-16160		160			3,490				
BJ600-16200		200					60	55	3,490
									4,370