

BJ152

DOUBLE-TAPERED STRAPS

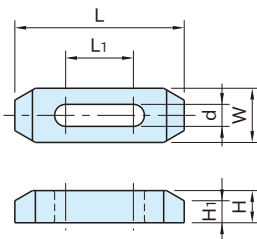

Body
Steel (S45C) Quenched and tempered Black oxide finish

Part Number	L	W	H	d	L ₁	H ₁	Clamping Force (kN)	Allowable Screw Torque (N·m)	Weight (kg)
BJ152-08063	63	25	12	9	25	7	6.9	22	0.1
BJ152-08080	80		32		0.15				
BJ152-08100	100	16	12	11	40	10	7.8	25	0.24
BJ152-10063	63	25			25				7
BJ152-10080	80	25	16	11	32	10	11.3	45	0.18
BJ152-10100	100				40				0.22
BJ152-10125	125	32	19	11	45	13	12.5	50	0.48
BJ152-10160	160				50				0.64
BJ152-12063	63	32	16	13	25	10	14.8	71	0.18
BJ152-12080	80				32				0.2
BJ152-12100	100	32	19	13	40	13	16.7	80	0.34
BJ152-12125	125				45				0.46
BJ152-12160	160	25	16	17	50	15	18.8	90	0.8
BJ152-16080	80	32			25				10
BJ152-16100	100	38	19	17	32	13	18	115	0.42
BJ152-16125	125				40				0.53
BJ152-16160	160	25	25	21	50	15	20.2	129	0.9
BJ152-20100	100	38			19				13
BJ152-20125	125	38	25	21	40	15	19.7	157	0.64
BJ152-20160	160				50				0.85
BJ152-20200	200	50	63	22.9	183	1.54			

How To Use

