

BJ070~072-MV

FOUR-SIDED BLOCKS FOR CLAMPING BASES

On Request

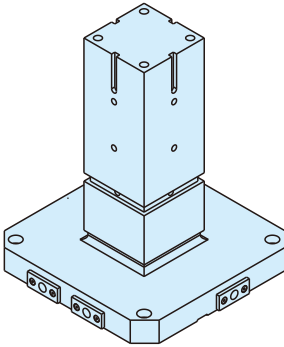

BJ070-4015MV

BJ071-4015MV

BJ072-4015MV

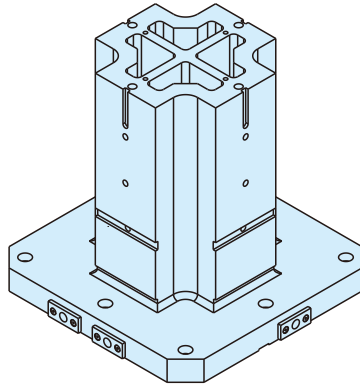

BJ070-5015MV

BJ071-5015MV

BJ072-5015MV

Body
FC300 cast iron
Annealed
Precision machined

- BJ070-4015MV**
- BJ071-4015MV**
- BJ072-4015MV**

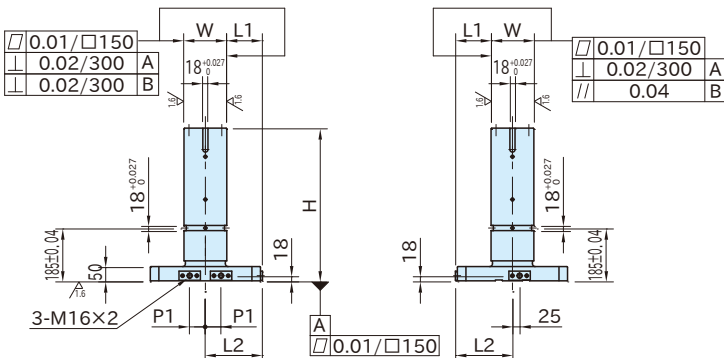
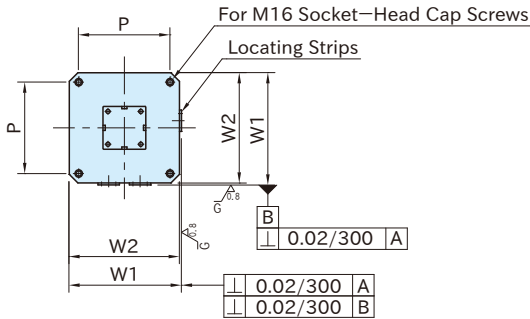

BJ070-5015MV
BJ071-5015MV
BJ072-5015MV

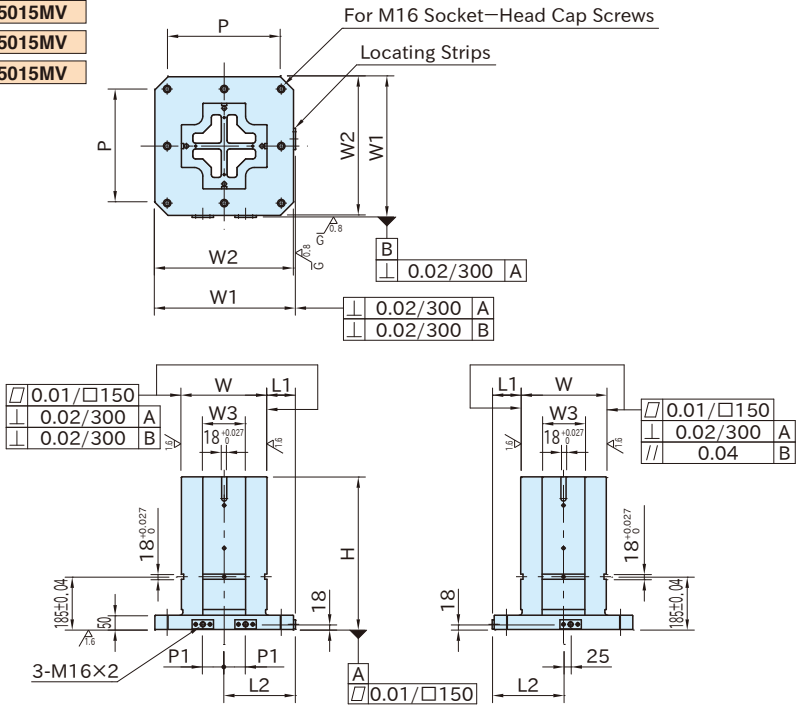

Part Number	Pallet Size	H	W (±0.04)	W1	W2	W3	L1 (±0.04)	L2 (±0.04)	P	P1
BJ070-4015MV	□400	485	150	393	386	-	125	200	320	55
BJ071-4015MV	□400	535								
BJ072-4015MV	□400	590								
BJ070-5015MV	□500	485	300	493	486	150	100	250	400	75
BJ071-5015MV	□500	535								
BJ072-5015MV	□500	590								

Part Number	No. of Mounting Holes	Proper Modular Vises	Weight (kg)
BJ070-4015MV	4	MVMF150×200	119
BJ071-4015MV		MVMF150×250	128
BJ072-4015MV		MVMF150×300	137
BJ070-5015MV	8	MVMF150×200	234
BJ071-5015MV		MVMF150×250	252
BJ072-5015MV		MVMF150×300	269

Furnished Parts
 2 of eye bolts

Features
 Four-sided blocks for mounting the Modular Vises.
 Custom blocks are available on request.

Notes

- For attaching the Modular Vises on **BJ070-4015MV**, **BJ071-4015MV**, **BJ072-4015MV**, use the Positioning Keys (to be ordered separately).
- These blocks are non-stock items.
- MVAC150VP** inserts are perfect for holding clamping units.

Positioning Key (Separately Sold)

Part Number	Proper 4-Sided Blocks
MVAC18FK-S	BJ07*-4015MV

This key is a non-stock item.