

# ST-H305, ST-H307

## 水平式肘节夹具、水平式肘节夹具(带安全机构)

**RHS SUS**

**STEEL-SMITH®**  
Clamps on the go... that never let go!

**NEW型号**  
红色标记



**ST-H-U**



**ST-H-U-L**

型号	本体	握把	螺栓、螺母	衬垫
<b>ST-H-U</b>	SPCC	聚氯乙烯薄膜	SUM41	氯丁二烯橡胶 (CR)
<b>ST-H-U-L</b>	镀锌		镀锌	
<b>ST-H-U-S</b>	SUS304L	SUS304	SUS304	
<b>ST-H-U-L-S</b>	电解研磨		电解研磨	

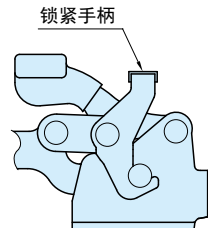
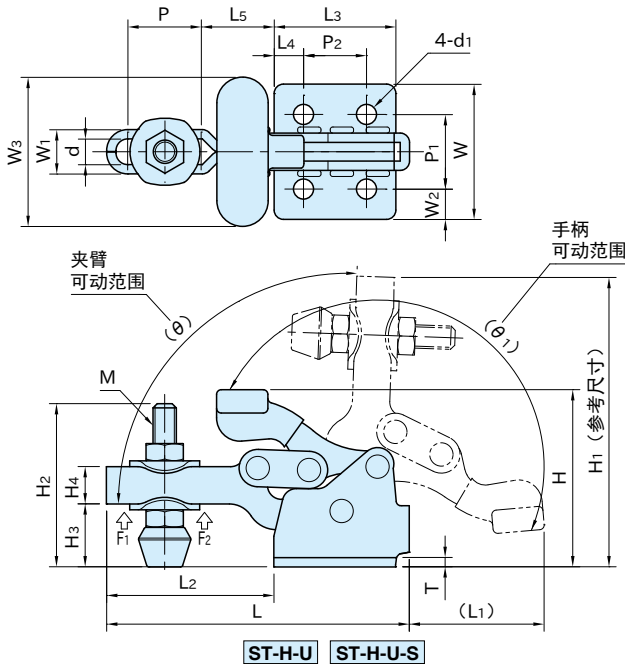

**ST-H-U-L**

**ST-H-U-L-S**

(带安全机构)

规格		$\theta$	$\theta_1$	M	H <sub>2</sub>	H <sub>3</sub>	d	P	L	H	W	L <sub>2</sub>	L <sub>3</sub>	T	d <sub>1</sub>
ST-H-U	305	92°	166°	M5	33	13.5	5.5	9.5	59	38	25.4	30	26.1	2	4.5
ST-H-U-L															
ST-H-U-S	307	88°	175°	M8	66	23.5	8.5	20	93	66	46.6	45	43.6	3	7
ST-H-U-L-S															

规格		P <sub>1</sub>	P <sub>2</sub>	W <sub>2</sub>	L <sub>4</sub>	L <sub>5</sub>	L <sub>1</sub>	H <sub>1</sub>	H <sub>4</sub>	W <sub>1</sub>	W <sub>3</sub>	压紧力	
												F <sub>1</sub> (kN)	F <sub>2</sub> (kN)
ST-H-U	305	16	13.5	4.7	6.3	16	31	57	8	9.5	31	0.2	0.5
ST-H-U-L													
ST-H-U-S	307	29.4	23	8.6	10.3	18	48	93	13	14.5	53	1.1	1.4
ST-H-U-L-S													

钢铁制		不锈钢制	
型号	质量(g)	型号	质量(g)
ST-H305U	60	ST-H305U-S	60
ST-H305U-L	70	ST-H305U-L-S	70
ST-H307U	260	ST-H307U-S	260
ST-H307U-L		ST-H307U-L-S	