

# BJ159

## 标准压板(带螺丝孔)

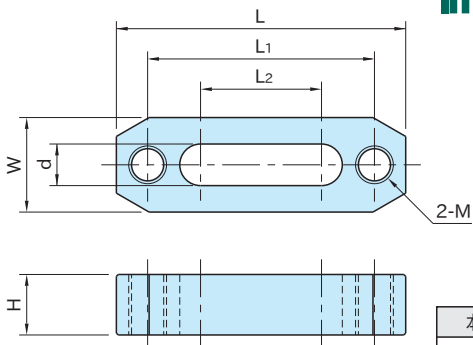

本体  
S45C  
淬火回火  
四氧化三铁膜

| 型 号         | L   | W  | H  | d  | L <sub>2</sub> | M        | L <sub>1</sub> | 夹紧力<br>(kN) | 容许紧固扭矩<br>(N·m) | 质量<br>(g) |
|-------------|-----|----|----|----|----------------|----------|----------------|-------------|-----------------|-----------|
| BJ159-08063 | 63  | 25 | 12 | 9  | 25             | M 8×1.25 | 49             | 6.9         | 22              | 95        |
| BJ159-08080 | 80  |    |    |    | 32             |          | 66             |             |                 | 130       |
| BJ159-10080 | 80  | 25 | 16 | 11 | 32             | M10×1.5  | 60             | 11.3        | 45              | 150       |
| BJ159-10100 | 100 |    |    |    | 40             |          | 80             |             |                 | 200       |
| BJ159-10125 | 125 |    |    |    | 45             |          | 105            |             |                 | 275       |
| BJ159-12100 | 100 | 32 | 19 | 13 | 40             | M12×1.75 | 80             | 16.7        | 80              | 320       |
| BJ159-12125 | 125 |    |    |    | 45             |          | 105            |             |                 | 425       |
| BJ159-12160 | 160 |    |    |    | 50             |          | 140            |             |                 | 675       |
| BJ159-16125 | 125 | 38 | 19 | 17 | 40             | M16×2    | 101            | 18          | 115             | 480       |
| BJ159-16160 | 160 |    |    |    | 22             |          | 136            |             |                 | 760       |
| BJ159-16200 | 200 |    |    |    | 25             |          | 176            |             |                 | 1125      |
| BJ159-20125 | 125 | 38 | 22 | 21 | 40             | M20×2.5  | 95             | 19.7        | 157             | 470       |
| BJ159-20160 | 160 |    |    |    | 50             |          | 130            |             |                 | 665       |
| BJ159-20200 | 200 |    |    |    | 50             |          | 170            |             |                 | 1445      |

### 使用示例及使用方法

