

# QLRC

# THRUST CLAMPS

## NEW ROHS



[Body/Lever Arm]

Material : S45C steel

Finish : Black oxide

[Cam]

Material : SCM415 steel

Heat treat : Carburized-hardened

Finish : Black oxide

[Handle]

Material : Phenolic plastic

Color : Black matte

T-4 Handle-Mounting Holes(provided every 90° angle)  
(4 options of mounting position)

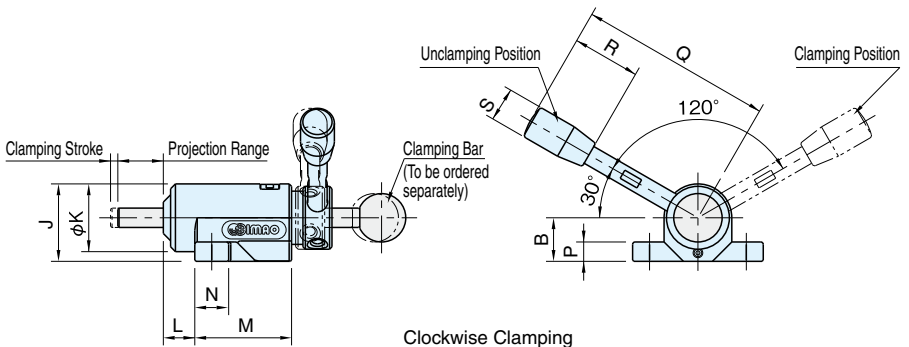
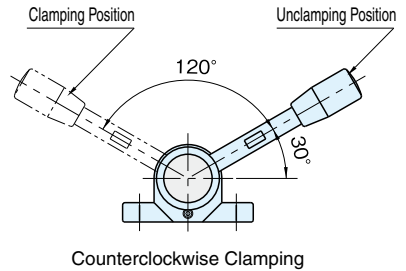
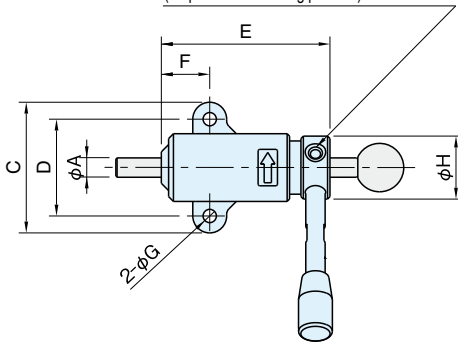

Part Number	Clamping Direction	Clamping Stroke	A	B	C	D	E	F	G	H	J	K	L	M
<b>QLRC-08R</b>	CW	1.5	8	18	54	40	70	20	5.5	26	32	28	13	40
<b>QLRC-08L</b>	CCW													
<b>QLRC-12R</b>	CW	2.3	12	25	80	60	96	30	9	36	45	40	20	55
<b>QLRC-12L</b>	CCW													

Part Number	N	P	Q	R	S	T	Allowable Operating Load (N)	Clamping Force (N)	Clamping-Bar Projection Range	Weight (g)	
<b>QLRC-08R</b>	14	8	80	28	14	M5X0.8	80	500	QLRCS-08100	0 - 30	330
<b>QLRC-08L</b>									QLRCS-08125	0 - 55	
									QLRCS-08150	0 - 80	
<b>QLRC-12R</b>	20	12	132	40	21	M6X1	150	1,400	QLRCS-12125	0 - 29	910
<b>QLRC-12L</b>									QLRCS-12150	0 - 54	
									QLRCS-12200	0-104	910

### How To Use

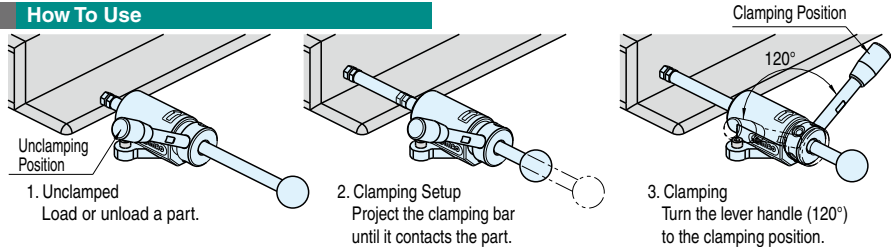

### Features:

- Spring-loaded clamp that provides constant clamping force.
  - Long clamping-bar projection range allows clamping a recessed part.
  - Clamping Bars are not included (must be ordered separately).
- (When using your own clamping bar, ensure that the diameter is finished to a h9 or better tolerance)

### Note :

When a reaction force (F) becomes greater than a clamping force, the clamping bar slides back to get a part unclamped.

Series	Clamping Is Released At:
<b>QLRC-08</b>	$F > 500$
<b>QLRC-12</b>	$F > 1,400$

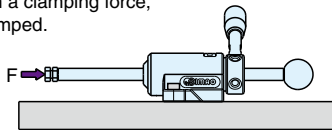

## QLRCS

## Clamping Bars

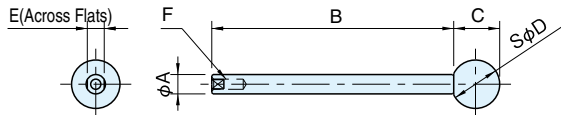

Part Number	A (f8)	B	C	D	E	F	Weight (g)
<b>QLRCS-08100</b>	8	100	19	20	7	M4X0.7-8 deep	50
<b>QLRCS-08125</b>		125					60
<b>QLRCS-08150</b>		150					70
<b>QLRCS-12125</b>	12	125	24	25	10	M6X1 -12 deep	130
<b>QLRCS-12150</b>		150					150
<b>QLRCS-12200</b>		200					190

[Arm] Material : S45C steel  
Finish : Chrome plated

[Ball Knob] Material : ABS resin  
Color : Black

- For exclusive use with Thrust Clamps.
- Can be cut shorter to a desired length.